

LOOP TACK TEST FIXTURE FOR INTERCHANGABLE SUBSTRATES

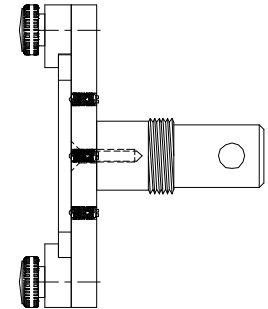
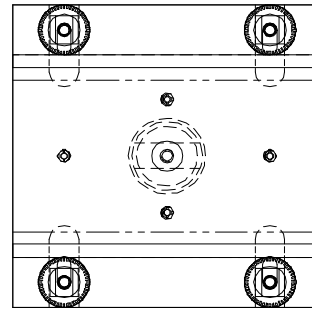
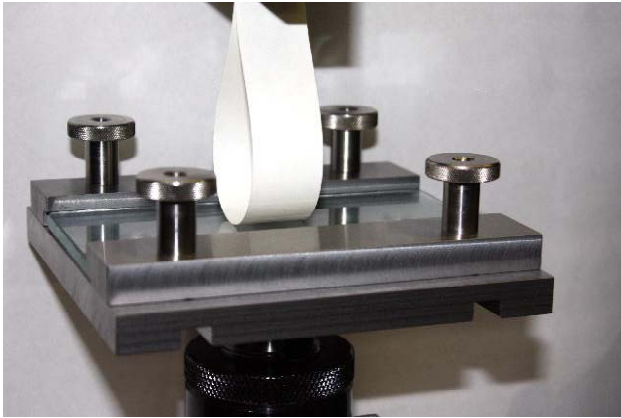

Model No.
ASTM.D6195.20

Specimen Size or Difference Between Fixtures
Up to 3" wide and 5" long

Construction
Stainless steel

Temperature
-120 to 250°F (-85 to 122°C)

Fixture:	Mounting	Top: Grip (not included) Bottom: 1.25" male clevis
	Capacity	5 lbs
	Weight	6" x 6" x 5"
	Dimensions	Manufactured in compliance with ASTM D6195
	Standard	

QUOTE

Model No. ASTM.D6195.20 - Loop Tack Test Fixture for Interchangeable Substrates

The fixture comes with a 4" wide horizontal platform with clamps to secure different substrates. The platform can hold a 4" by 6" and up to 0.125" thick substrate. The loop is held in place with a tensile grip (grip sold separately) and the horizontal platform is supplied with a 1.25" male clevis adapter for mounting to your test frame. The fixture is constructed of stainless steel and manufactured in compliance with ASTM D6195.

ACCESSORIES

Model No. Grip.10100.1101 - (1) 200lbs Screw Action Grip with 1" Square Grip Faces

Model No. DIE.D6195.0001 - Rectangular Specimen Cutting Die - 4" Gauge Length, 1" Gauge Width, 5" Total Length

SPARE PARTS

Model No. SPA.D6195.2001 - Extra Set Of Sliding Support Rails To Accommodate Specimen Thicknesses of 0.125" to 0.25"

Model No. SPA.D6195.2002 - Extra Set of (2) 4" Wide by 6" Long Stainless Steel Substrate Panels

COMMON SIZE ADAPTERS

Upper Mounting: Grip:

Model No. Grip.10100.1101- (1) 200lbs Screw Action Grip with 1" Square Grip Faces

Lower Mounting: 1.25" Male Clevis

Model No. M03S60 - 1.25" Male Clevis to 2"-12 Threaded Stud

Model No. M03S48 - 1.25" Male Clevis to 1.5"-12 Threaded Stud

Model No. M03S42 - 1.25" Male Clevis to 1.25"-12 Threaded Stud

Model No. M03S36 - 1.25" Male Clevis to 1"-14 Threaded Stud

EXTRA PHOTOS:

